

4

3

2

1

REPLACEMENT PARTS

ITEM NO.	PART NUMBER	DESCRIPTION	QTY.
1	ITD7050	Plastic Knob with Four Arm Grip	1
2	ITD7099	1004-1045 Carbon Steel Linch Pin, Yellow Zinc-Plated	1
3	ITD25546	LOW PROFILE AXLE MOUNT - LOCK	1
4	ITD25663	LOW PROFILE AXLE MOUNT HARDWARE KIT	1

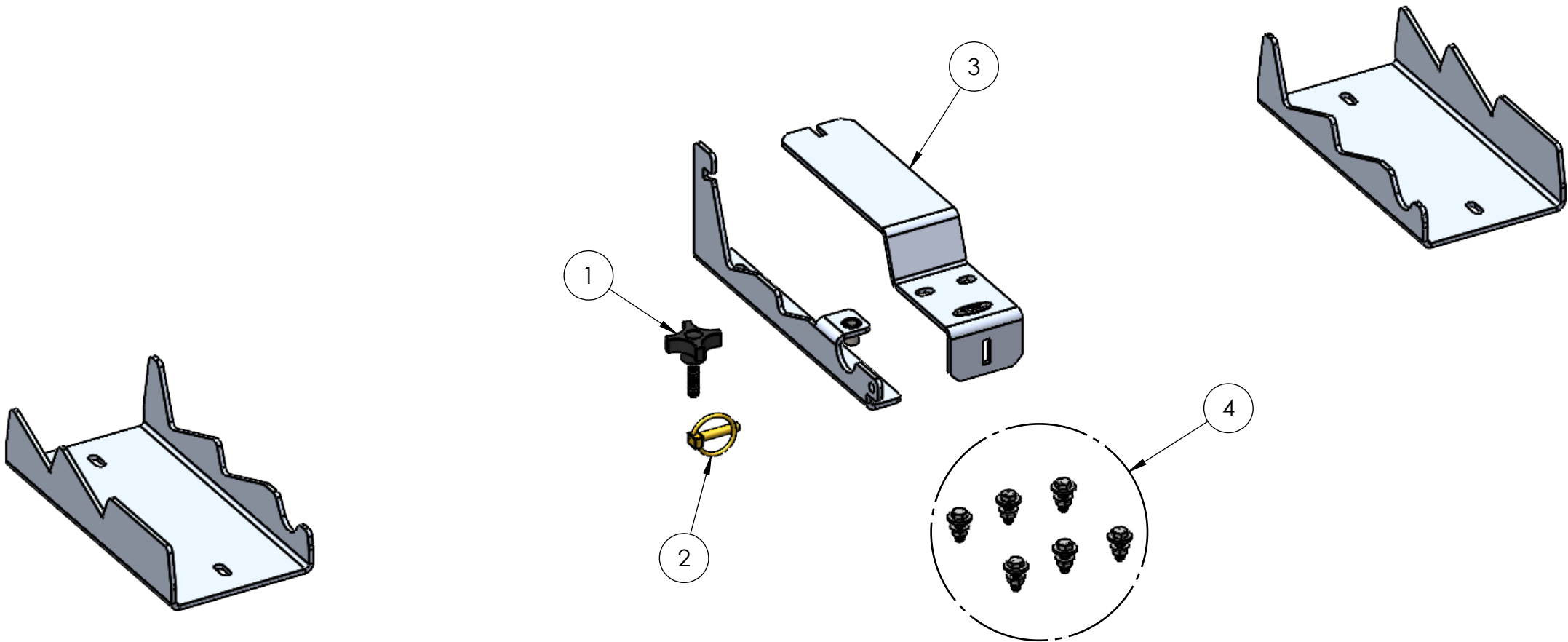

UNLESS OTHERWISE SPECIFIED				NAME		DATE		<div>inventive-group</div> <div>One Company, 4 Brands</div>					
TOLERANCES:		DRAWN		KM				TITLE: LOW PROFILE AXLE MOUNT					
ANGULAR: BEND ± 0.3° FRACTIONAL ± 1/16" TWO PLACE DECIMAL ± 0.020" THREE PLACE DECIMAL ± 0.010"		ENG APPR.											
GD&T ASME Y14.5-2018		PROPRIETARY AND CONFIDENTIAL											
TOP LEVEL ASSEMBLY P/N ITD25543		THE INFORMATION CONTAINED IN THIS DRAWING IS THE SOLE PROPERTY OF INVENTIVE GROUP LLC. ANY REPRODUCTION IN PART OR AS A WHOLE WITHOUT THE WRITTEN PERMISSION OF INVENTIVE GROUP LLC. IS PROHIBITED.											
MATERIAL VARIES								SIZE B		PART NUMBER: ITD25543		REV	
FINISH VARIES								WEIGHT		5.75 LBS			
		SURFACE AREA		696.54		SQ IN		SCALE: 1:5		DO NOT SCALE DRAWING		SHEET 1 OF 2	

4

3

2

1

DIMENSIONS

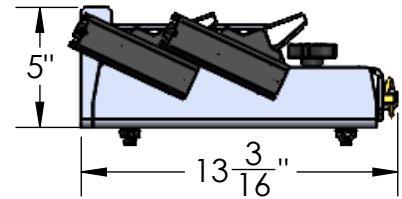
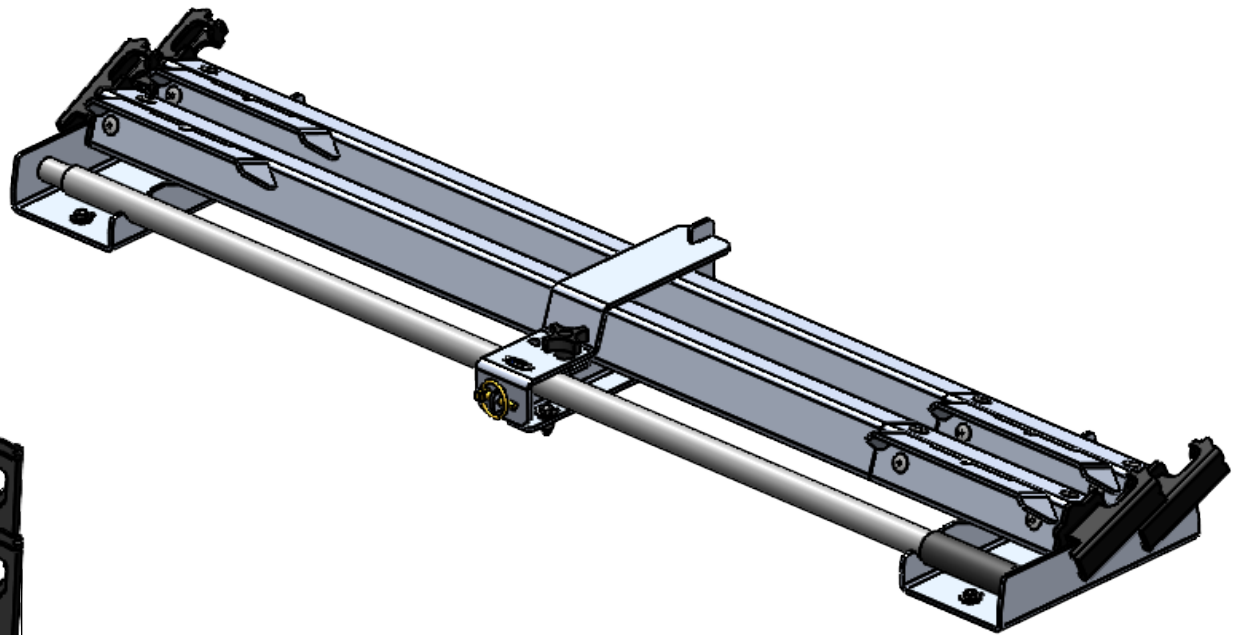
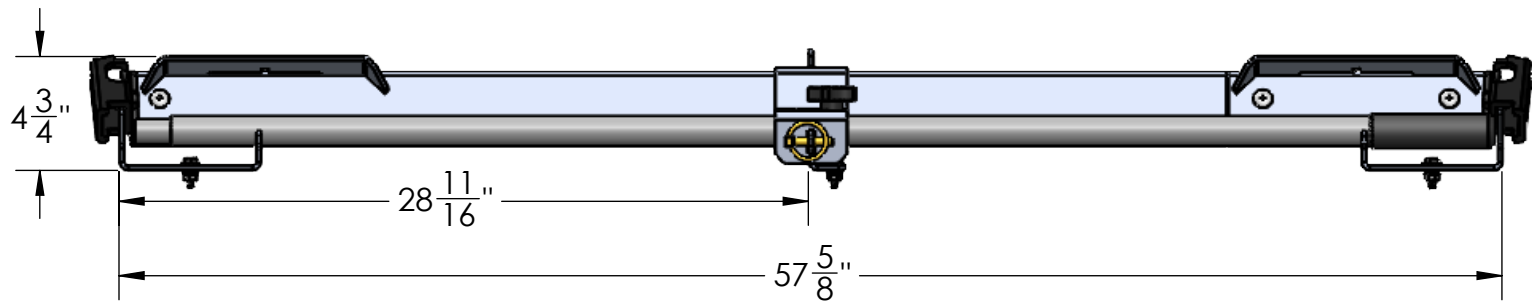
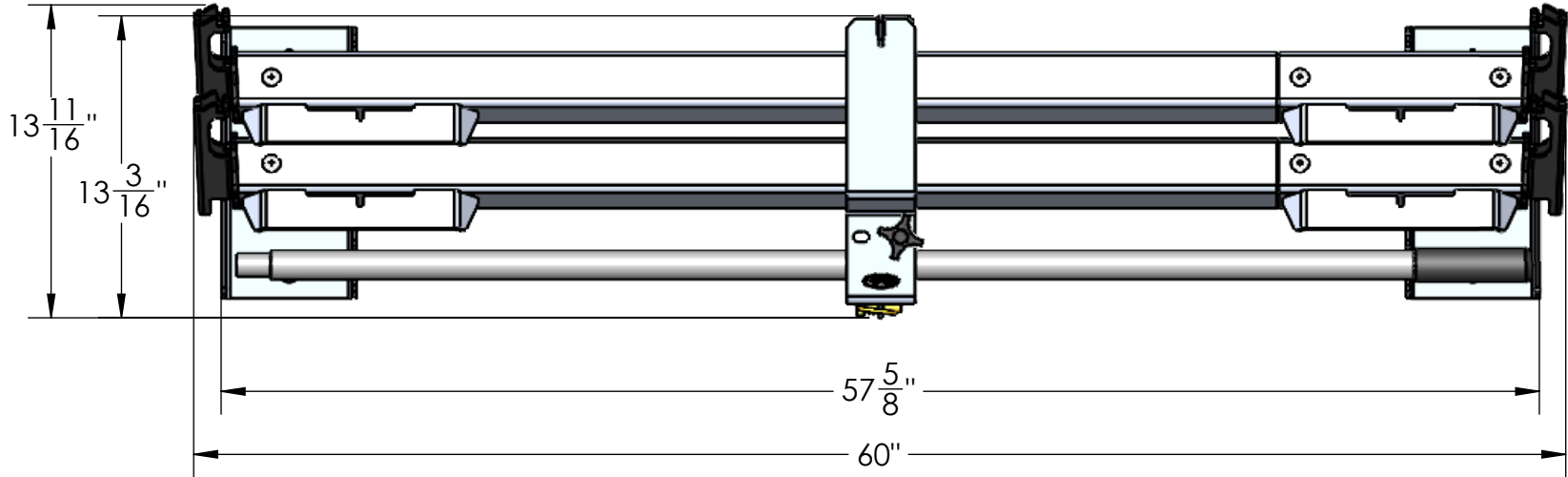

UNLESS OTHERWISE SPECIFIED		NAME		DATE		<div>inventive-group</div> <div>One Company, 4 Brands</div>					
TOLERANCES:		DRAWN		KM		TITLE: LOW PROFILE AXLE MOUNT					
ANGULAR: BEND ± 0.3° FRACTIONAL ± 1/16" TWO PLACE DECIMAL ± 0.020" THREE PLACE DECIMAL ± 0.010"		ENG APPR.									
GD&T ASME Y14.5-2018		PROPRIETARY AND CONFIDENTIAL									
TOP LEVEL ASSEMBLY P/N ITD25543		THE INFORMATION CONTAINED IN THIS DRAWING IS THE SOLE PROPERTY OF INVENTIVE GROUP LLC. ANY REPRODUCTION IN PART OR AS A WHOLE WITHOUT THE WRITTEN PERMISSION OF INVENTIVE GROUP LLC, IS PROHIBITED.									
MATERIAL VARIES		WEIGHT		59.62 LBS		SIZE B		PART NUMBER: ITD25543		REV	
FINISH VARIES											
		SURFACE AREA		5280.99 SQ IN		SCALE: 1:8		DO NOT SCALE DRAWING		SHEET 2 OF 2	