

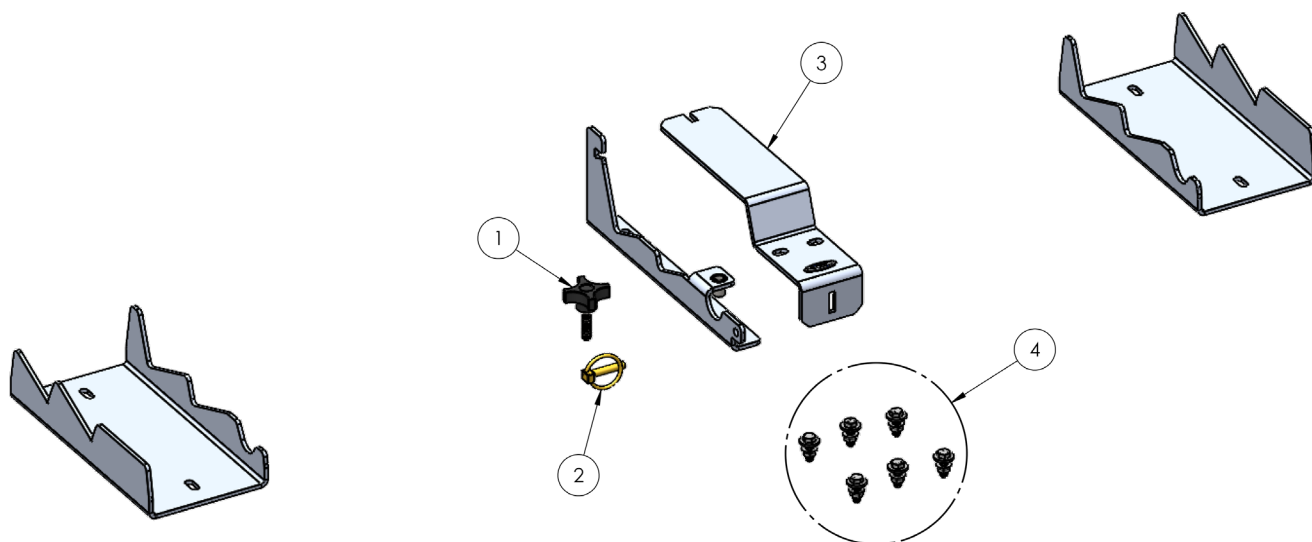

## LOW PROFILE AXLE MOUNT REPLACEMENT PARTS



**208-587-7960**  
**WWW.INTHEDITCH.COM**

# REPLACEMENT PARTS

ITEM #	PART #	DESCRIPTION	QTY
<b>LOW PROFILE AXLE MOUNT</b>			
1	ITD7050	Plastic Knob with Four Arm Grip	1
2	ITD7099	1004-1045 Carbon Steel Linch Pin, Yellow Zinc Plated	1
3	ITD25546	Low Profile Axle Mount Lock	1
4	ITD25663	Low Profile Axle Mount Hardware Kit	1

PART #	DESCRIPTION
ITD25543	Low Profile Axle Mount

## ATTENTION

**Please Note: Due to contributing factors beyond our control that could cause rust, staining, or discoloration of Polished Surfaces, In The Ditch Towing Products does not warranty polished stainless steel panels. In an effort to keep your stainless looking its best, please visit [www.intheditch.com](http://www.intheditch.com) to find the best practices for maintaining your polished stainless-steel products. By following our maintenance recommendation, your polished stainless steel should look great for years to come.**