

DIMENSIONS

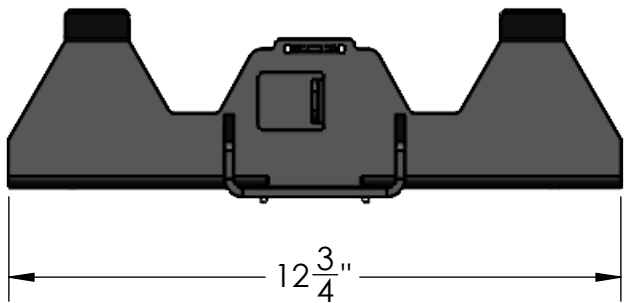
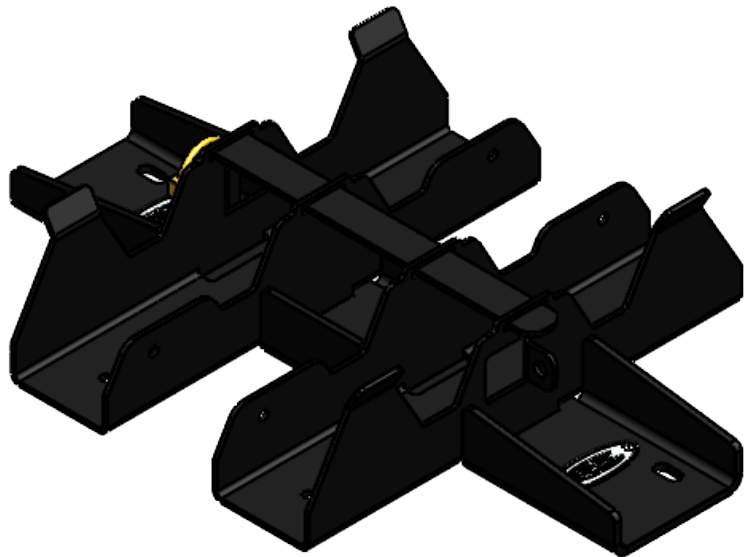
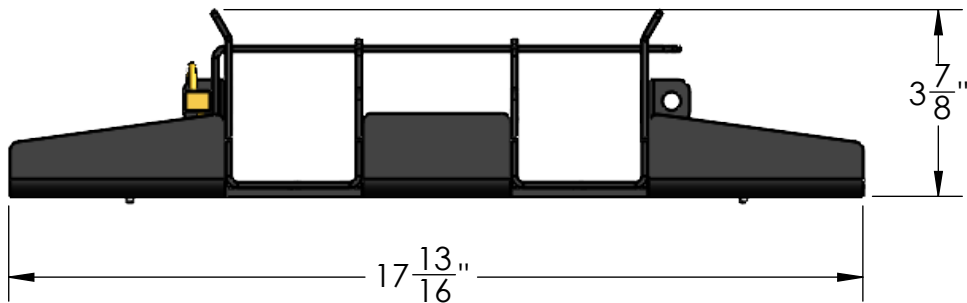
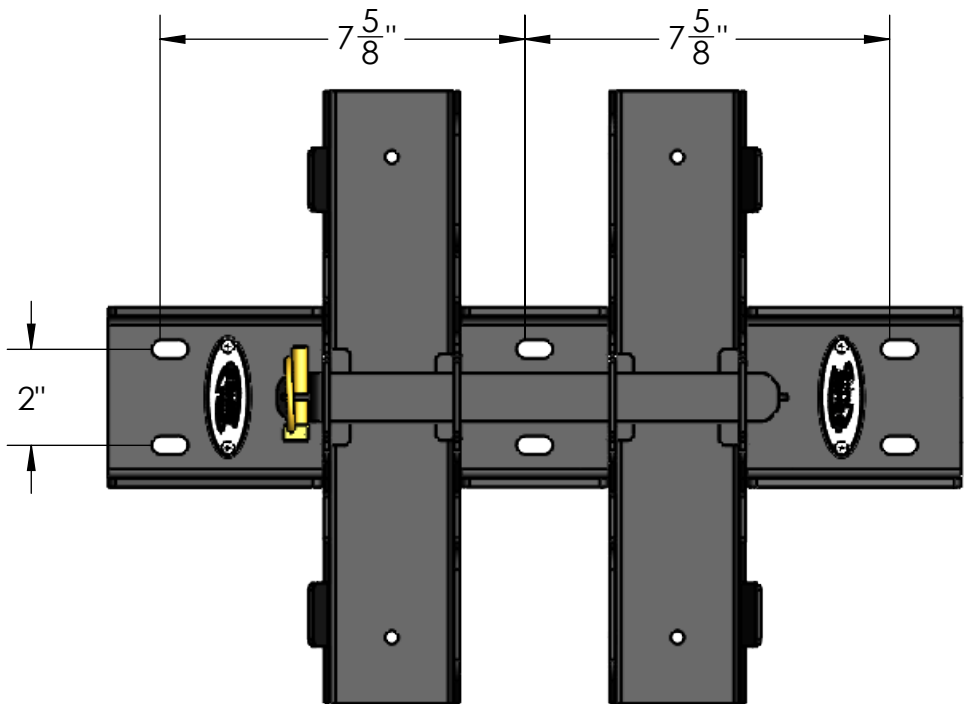

UNLESS OTHERWISE SPECIFIED		NAME		DATE		<div>inventive-group</div> <div>One Company, 4 Brands</div>					
TOLERANCES:		DRAWN		WU							
ANGULAR: BEND ± 0.3°		ENG APPR.				TITLE: QUICK MOUNT DOLLY MOUNT - ASSEMBLY					
FRACTIONAL ± 1/16"											
TWO PLACE DECIMAL ± 0.020"											
THREE PLACE DECIMAL ± 0.010"											
GD&T ASME Y14.5-2018		PROPRIETARY AND CONFIDENTIAL									
TOP LEVEL ASSEMBLY P/N		THE INFORMATION CONTAINED IN THIS DRAWING IS THE SOLE PROPERTY OF INVENTIVE GROUP LLC. ANY REPRODUCTION IN PART OR AS A WHOLE WITHOUT THE WRITTEN PERMISSION OF INVENTIVE GROUP LLC, IS PROHIBITED.									
MATERIAL VARIES						SIZE B		PART NUMBER: ITD25099		REV	
FINISH VARIES						WEIGHT 27636.68 LBS		SCALE: 1:4		DO NOT SCALE DRAWING	
		SURFACE AREA 171713.58 SQ IN									

REPLACEMENT PARTS

ITEM NO.	PART NUMBER	DESCRIPTION	QTY.
1	ITD7099	REPLACEMENT - 5/16" LYNCH PIN	1
2	ITD25102	REPLACEMENT - SIMPLE LOCK FOR ITD25099	1

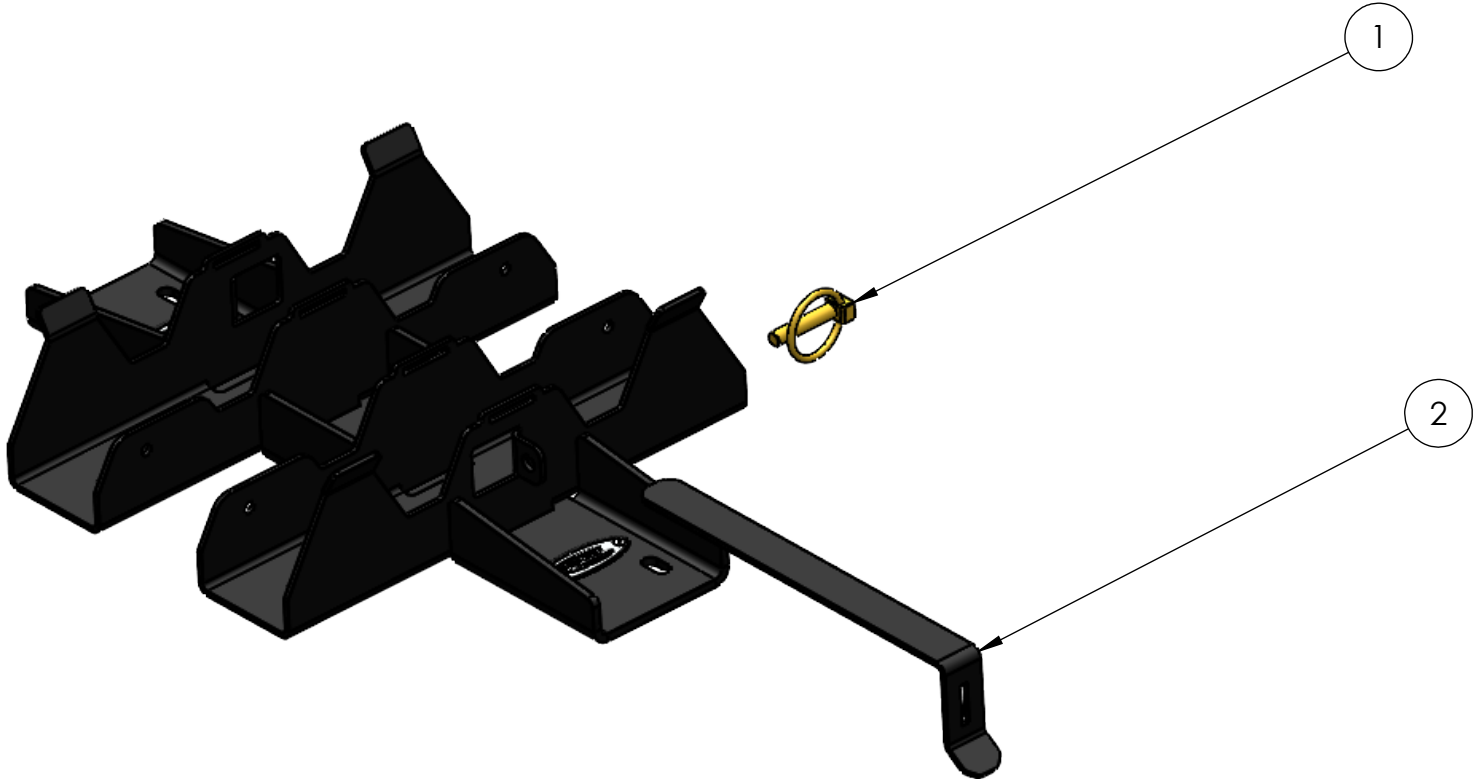

UNLESS OTHERWISE SPECIFIED		NAME		DATE		<div>inventive-group</div> <div>One Company, 4 Brands</div>					
TOLERANCES:		DRAWN		WU		TITLE: QUICK MOUNT DOLLY MOUNT - ASSEMBLY					
ANGULAR: BEND ± 0.3° FRACTIONAL ± 1/16" TWO PLACE DECIMAL ± 0.020" THREE PLACE DECIMAL ± 0.010"		ENG APPR.									
GD&T ASME Y14.5-2018		PROPRIETARY AND CONFIDENTIAL									
TOP LEVEL ASSEMBLY P/N		THE INFORMATION CONTAINED IN THIS DRAWING IS THE SOLE PROPERTY OF INVENTIVE GROUP LLC. ANY REPRODUCTION IN PART OR AS A WHOLE WITHOUT THE WRITTEN PERMISSION OF INVENTIVE GROUP LLC, IS PROHIBITED.									
MATERIAL VARIES						SIZE B		PART NUMBER: ITD25099		REV	
FINISH VARIES						WEIGHT 27636.68 LBS		SCALE: 1:4		DO NOT SCALE DRAWING	
		SURFACE AREA 171713.58 SQ IN									